



Wir öffnen  
Welten



**Requirements to protect against lightning**  
**CAUTION! Device damage due to overvoltage.**  
Secure the low voltage system against overvoltage.

**PRODUCT INFORMATION** (brief)  
Audio and Audio PLUS-indoor station  
Series TASTA

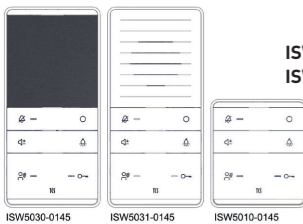

**ISW5010-0145 Audio**  
**ISW5030-0145 Audio PLUS**  
**ISW5031-0145 Audio PLUS**

German / English

**SCOPE OF DELIVERY**

- 1 x indoor station
- 1 x mounting tray
- 1 x installation guide
- 1 x user manual (brief)



**NOTES ON THE INSTRUCTION**

The installation guide refers exclusively to qualified electricians. Please scan the QR Code for detailed information or go to: [tcsag.de/download](http://tcsag.de/download).

The installation guide contains important notes on the intended use, installation and commissioning of the product. Please keep the installation guide in a suitable place where it can be easily accessed for maintenance and repair works

**SAFETY INSTRUCTION**

**General safety instruction**  
Assembly, installation, commissioning and repair of electronic devices must be carried out by qualified electricians. Observe the latest regulations and standards for system installations.

**WARNING! Danger due to electric shock.**  
Observe the safety regulations according to DIN VDE 0100, when working on main power connections of 230 V.

When installing TCS:BUS systems the general safety regulations for telecommunication systems according to VDE 0800 must be observed. Inter alia:  
> separated cable routing of high and low voltage lines,  
> minimum distance of 10 cm in case of a common cable routing,  
> use of separators between high and low voltage lines within shared cable ducts,  
> use of standard telecommunication lines, e.g. J-Y (St) Y with 0.8 mm diameter,  
> already existing lines (modernisation) with deviating cross-sections can be used in compliance with the loop resistance.

**CAUTION! Not suitable for call systems according to DIN VDE 0834 and 50134.**

The ISW5010-, ISW5030- and ISW5031-0145 does NOT meet the requirements according to DIN VDE 0834 and DIN EN50134. For callers or third parties a more or less imminent danger can occur, if e.g. calls are not signalled or if defects or disturbances are not recognised in time.

- The indoor station must not be used in call systems according to DIN VDE 0834 and EN50134.
- According to DIN 77800, a separate safeguard for emergency call has to be installed.
- A system equipped with this indoor station is not an emergency call system according to the above mentioned standards.
- The indoor station must not be used in life-saving or life-sustaining systems.
- Further the combination of system parts which fulfill the above mentioned standards is not permitted.

**INTENDED USE**

ISW5031-0145, ISW5030-0145 and ISW5010-0145 are audio indoor stations for hands free talking. There are suitable for the operation in TCS audio systems and combined audio/video systems. Type of mounting: surface-mount or as table-top device with desktop accessory ZIT5000-0030.

The manufacturer accepts no liability for any uses differing from or exceeding the intended use.

**INDICATION- AND OPERATING ELEMENTS**

- Loudspeaker**
- Microphone**
- Function button**  
> send control function 8, send internal call, door release automatic on/off or call diversion on/off configurable
- Light switch button**  
> switch light, send control function 9 or internal call 2  
> ring tone selection: floor call (from flat door)  
> ambient illumination: press for 4 s, to de-/activate
- Door release button**  
> open the door  
> trigger light switch function, if the light switch function is activated in the front-door station  
> quit speaking: voice connection is terminated after 4 sec automatically  
> ring tone selection: door call 1 from front-door station (ring tone <= ring tone AS)
- Indication for door release, blue LED**  
> OFF: door opener in standby  
> ON: door release automatic is activated  
> ON for 3 sec: door will be opened
- Ambient illumination, LED blue**  
> OFF: temporary (manually) or permanently switched off  
> ON: temporary (manually) or permanently switched on  
> blinks: call indication (e.g. door and internal call)
- Call indication, LED green**  
> LED off: in standby  
> LED on: call, speaking activated  
> blinks 3 x: speech channel is busy
- Speech button**  
> shortly press: call acceptance, speaking is activated  
> press for 2 sec: activate simplex communication  
> shortly press: quit speaking  
> shortly press when selecting ring tones: door call 2  
> from the front-door station (ring tone > ring tone AS)

- Volume button**  
> Setting the ring tone volume in 4 steps, when no voice-connection is established.  
> Setting the volume of the voice output in 4 steps when a voice connection is established.
- Smart Slot**  
> For additional signalling of door calls (can be ordered as accessory).
- Call OFF button**  
> shortly press: ring tone mute is activated  
> press for 8 sec: initiate ring tone selection  
> shortly press: quit ring tone selection  
> press for 2 sec: quit (half-)duplex communication
- LED indication (red) ring tone mute**  
> indication call OFF is on: ring tone mute is activated  
> OFF: ring tone mute is deactivated  
> flashes: call diversion is activated, ring tone mute is deactivated  
> LED turns off in longer periods: call diversion is activated, ring tone mute is activated  
**all LEDs:**  
> All LEDs are on: ring tone selection is activated  
> LEDs flashing: device or TCS:BUS error

**MOUNTING AND INSTALLATION**

**Mounting height**  
For an optimal operation, install the indoor station at 1.60 m.

**Install the mounting tray**  
Observe the installation position of mounting tray. It is marked by an arrow and the designation TOP.

The mounting tray can be installed directly to the wall or on a flush-mount socket.

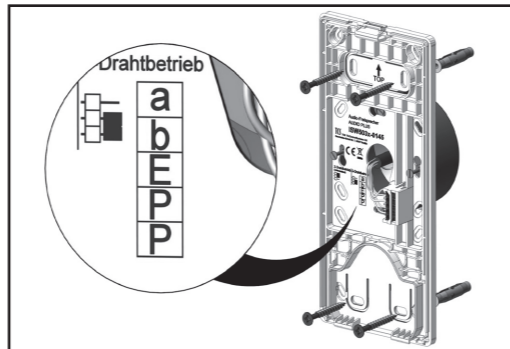

Guide the connection cable through the cable gland. Connect the wires to the terminal (a, b, E, P and P). Fix the mounting tray with suitable screws to the wall or on the flush-mount socket.

**Snap-on the device on the mounting tray**  
Put the device onto both adjustment increments (1). Press the device against the latch until it snaps on (2).  
**Remove the device from the mounting tray**  
Insert a screw driver with slight pressure into the release opening (1). Pull off the device to the front at its upper side. Lift the device out of the adjustment increments (2).

**Connecting the floor push button**  
Connect the floor push button to the terminals E - P an.  
Alternatively you can connect the floor push button to the terminals a - E. Ensure that the a-wire of the control unit is connected to the a-terminal of the indoor station.

**EXCAMPLE CIRCUIT**

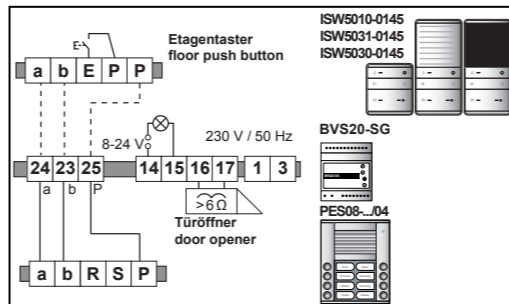

**COMMISSIONING**

Install all devices of the system completely. Check all wire against each other on short-circuit. Switch on the mains power.

**Fault detection and indication**  
Faults are signalled optically and acoustically: constant flashing and when pressing any button, an error tone sounds. The optical error indication stays active until the error is corrected.

- Error tone sounds once long and three times short:**  
> a- and P-wire are interchanged or short-circuited  
> change a- and P-wire or eliminate short-circuit, device is in stand-by mode again
- Error tone sounds once long and twice short:**  
> a-wire is not connected or not supplied  
> connect the a-wire or check power supply, device is in stand-by mode again
- Error tone sounds once long and once short:**  
> button sticks (press longer than 15 sec)  
> remove button at the device or loosen floor push button, device is in stand-by mode again

**BELL BUTTON PROGRAMMING**

**Requirements for the programming:**  
> Ensure that the access to the indoor station in the flat is granted.  
> Check if the indoor station is connected to the TCS:BUS.  
> Switch on the mains voltage. The operating LED at the power supply and control unit is on.  
> Check if a programming lock is set. If the programming lock is activated, you cannot program any bell button. To deactivate the programming lock you need a Service Device TCSK or the configuration software configo™.  
> For device-specific indication modes of the front-door station see product information of the front-door station.

- Control unit: Switching on the programming mode of the systems**  
> shortly press the RUN/PROG button <sup>a)</sup>  
> LED blinks  
> programming mode is activated
- Programming via voice connection**  
> press the speech button  
> shortly press the bell button  
> ring tone sounds at the front-door and indoor station <sup>d)</sup>  
> press the speech or door release button
- Control unit: Switching off the programming mode of the system**  
> shortly press the RUN/PROG button  
> LED lights up  
> programming mode is deactivated <sup>e)</sup>

**Deleting bell buttons <sup>b)</sup>**  
> press the bell button that is to be deleted for around 6 sec until an acknowledgement tone sounds <sup>e)</sup>  
> release the bell button  
> previously execute step 1 and then step 3

**NOTES:**  
a) Do not press the RUN/PROG button longer than 5 sec. Otherwise you will activate the light switch function of the front-door station. The bell button cannot be programmed.  
Repair:  
> If the LED blinks, shortly press the RUN/PROG button to deactivate the programming mode.

- > Press the RUN/PROG button only short to activate the programming mode.
- > Programm the the bell button
- b) Not necessary, if the bell buttons have not been programmed, see product information of the front-door station.
- c) If there sounds a Prosperr tone (long high tone followed by long low tone) instead, the front-door station is equipped with a programming lock. You can deactivate the programming lock only with the Service Device TCSK or the configuration software configo™.
- Further information (parallel call with only one bell button) can be found in the system manual, in the download area at [www.tcsag.de](http://www.tcsag.de) or by scanning the QR code.

**2-WIRE/ 3-WIRE OPERATION**

- 2-wire operation:**  
> 2-wire operation (delivery state): The jumper J1 is set for 2-wire operation.
- 3-wire operation:**  
> Plug the jumper J1 onto both lower contacts or remove the jumper J1.

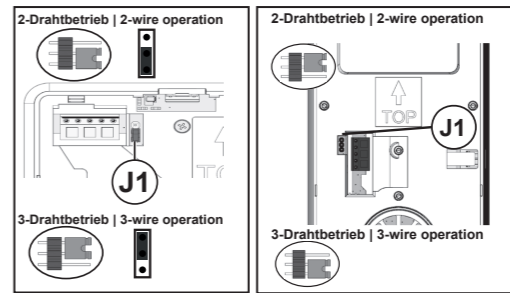

ISW5010-0145 ISW5030-0145 | ISW5031-0145

**PROGRAMMING WITH SERVICE DEVICE TCSK**

search device	*52#
<b>Function button:</b>	
call diversion	*90#Ser.-Nr.#ZielSNr.#
automatic door release	*91#Ser.-Nr.#
intern call	*92#Ser.-Nr.#IntSNr.#
control function 8	*93#Ser.-Nr.#
<b>Light switch button:</b>	
intern call 2	*94#Ser.-Nr.#IntSNr.#
control function 9	*95#Ser.-Nr.#
light switch	*96#Ser.-Nr.#
switch ON parallel call	*99#Ser.-Nr.#ParSNr.#
switch OFF parallel call	*99#Ser.-Nr.# 0 #

**OPERATION**

- accept/quit a call:**  
> Shortly press the speech button to accept the call.  
> Shortly press the speech button again to terminate the conversation.
- Door release:**  
> Shortly press the door release button to open the door. The conversation is terminated automatically after 4 seconds
- Simplex communication de-/activate**  
> Press the speech button for at least 2 seconds after you have accepted the call to activate the function simplex communication.  
> Press the call OFF button to end the simplex communication mode.  
> Press the speech button to speak.  
> Release the speech button to hear your conversation partner.
- Adjust volume**  
Voice output:  
> Repeatedly press the volume button until you have adjusted the required volume for the voice output.  
Ring tone:  
> Repeatedly press the volume button in stand-by-mode. The ring tone sounds in the adjusted volume.
- Ambient illumination ON/OFF**  
> Press the Light switch button longer than 4 s.

**TECHNICAL SPECIFICATIONS**

	ISW5010-0145	ISW5030-0145	ISW5031-0145
Supply voltage (TCS:BUS supply unit)	+24 V ± 8 %	+24 V ± 8 %	+24 V ± 8 %
Input current (2-wire technique)	I(a) 1,90 mA	2,0 mA	2,0 mA
Input current (3-wire technique)	I(a) 0,16 mA I(P <sub>standby</sub> ) 1,68 mA I(P <sub>max</sub> ) 103 mA	0,20 mA 1,80 mA 75,0 mA	0,20 mA 1,80 mA 75,0 mA
Degree of protection	IP30		
Acceptable ambient temperature	- 5 ...+ 40 °C		
Housing	plastics ASA, white glossy		
Dimensions	Height 105 mm Width 94 mm Depth 21 mm (mounting tray)	195 mm	
Weight	105 g	188 g	

**Ring tone selection**  
> Press the call OFF button for 8 seconds, when no voice connection is established. All LEDs are ON and an acknowledgement tone sounds. The different ring tones can be selected via the different buttons, see indication- and operating elements.  
> Shortly press the call OFF button to end the ring tone selection.

**SPARE PARTS, ACCESSORY**

- Mounting tray ISW5010-0145 .....ZIA5001-0145
- Mounting plate ISW5010-0145 .....ZIA5003-0145
- Mounting tray ISW5030/31-0145 .....ZIA5005-0145
- Desktop accessory .....ZIT5000-0030
- Radio signal device .....FFL2200-0
- Video-2-wire:BUS-matching resistor .....0038794

**NOTES**

**CONFORMITY**  
Declarations of conformity are available for download at [www.tcsag.de](http://www.tcsag.de). Downloads, trade information.

**INFORMATION ON DISPOSAL**  
Dispose the device separately from domestic waste via a collection point for electronic scrap. Ask your county administration for the responsible collection point.

Dispose the parts of the packaging in collecting tanks for cardboard and paper resp. plastics.

**WARRANTY**

We offer a simplified processing in case of warranty for qualified electricians.  
> Please contact the TCS HOTLINE under 4194 9881-188 or [hotline@tcsag.de](mailto:hotline@tcsag.de)  
> Our standard terms and conditions of sale you'll find under [www.tcsag.de](http://www.tcsag.de), Downloads as well as our current product catalogue.

Service  
Please send your questions and inquiries to TCS HOTLINE 04194 9881-188 or [hotline@tcsag.de](mailto:hotline@tcsag.de)

**TCS TürControlSysteme AG**  
Geschwister-Scholl-Straße 7  
D-39307 Genthin  
Telefon: +49 3933 8799-10  
Fax: +49 3933 8799-11  
[www.tcsag.de](http://www.tcsag.de)

**TCS Österreich GmbH**  
Gewerbepark 21  
A-2821 Lanzenkirchen  
Telefon: +43 2627 45266-0  
Fax: +43 2627 45266-20  
[www.tcs-austria.at](http://www.tcs-austria.at)

